

PURPOSE LIFE

Ladies

HANDBOOK

DIVE INTO PASTOR SHARESE'S

heart

Hello Ladies!

Healthy, kingdom connections are important to our growth as women, daughters, mothers, sisters, wives, and friends. **The Women's Gathering** is not just another meetup or opportunity to discuss important matters that we have a gift to address. It's a time for genuine connection, authentic relationship building, and the establishment of a sisterhood I believe God desires for us to have and steward well.

Truth is, I couldn't be who I am without you and we need each other to continue thriving, building, growing, learning, creating, remaining grounded, and being effective, loving, powerful women of God.

Our Heavenly Father sees us, knows us well, and is clear about what we need. My hope is that **The Women's Gathering** will reflect the Father's heart in our connecting and learning more about the sister we speak to daily, see weekly, or pray for, as God leads. I also hope new friendships will be birthed.

It's important that we know who is "in the room" so we can become a strong sisterhood with an unmatched ability to support, strengthen, and strive together.

I'm excited to spend this time with you!

Love,

Pastor Sharese



LET'S PEEK INTO PASTOR SHARESE'S *season*

Q: What book are you currently reading?

A: Upon Waking
Jackie Hill Perry

Q: Which book of the Bible has your attention right now?

A: Esther

Q: What is your go to worship song for this season?

A: Always
by Jovanta Patton

Q: Are there any foods that you get cravings for right now?

A: Any Type of Berry

Q: What is the cry of your heart to Abba right now in one phrase?

Honestly, that's a big one this season because my heart has been so full. Let's just say He knows my cry very well and has been intentional about meeting me. But I will always have a special cry for daughters... I truly believe this is a birthing season for daughters and we will see so many answered prayers.



MEET THE BOARD



*pastor
sharese*



yolande



bianca



esther



wendy



fatima



rebekah

We are looking forward to adding more amazing women to our team!

PLC LADIES EVENTS

upcoming events

BOWLING

WORLD SPA DAY TRIP

SUNDAY BRUNCH

SIP 'N' PAINT

SUMMER PICNIC



whose WHO?

Our goal with PLC Ladies is also to find **purpose and value in meaningful connections**. *Genuine community is at the heart of what we do and its the core value that holds us together.* We desire to thrive together and to **build our nets** as we all come into the alignment of who God has called us to be. As we build this segment, feel free to use it to identify who labors among you!

**SCAN OUR QR CODE BELOW TO
SHARE MORE INFORMATION ABOUT
YOURSELF. WE ARE EXCITED TO
CONNECT WITH YOU!**



DUES: OUR COMMITMENT TO BUILD

importance

Regular contributions are a critical part of ensuring the success and sustainability of our ministry. These contributions are the lifeblood of our organization and allow us to continue to provide important programs and services to our community. Every dollar we receive in regular contributions goes towards furthering our mission and supporting those in need.

benefits

Contributing dues allows us to be more effective in all that we do, making a greater impact in the lives of those we serve. Additionally, consistent giving helps to ensure that we have a stable source of income throughout the year, rather than relying solely on periodic donations or fundraising events. This stability allows us to focus more on our local and global missions - which consists of but not limited to:

- bereavement in our sister community
- scholarships
- helping sisters build

LOCAL AND GLOBAL MISSIONS



Scholarships and Funds for Building Businesses

Bereavement and Urgent Community Needs



Global Missions and International Efforts

how to ACCESS THE APP:

DOWNLOAD THE PLC APP IN THE:

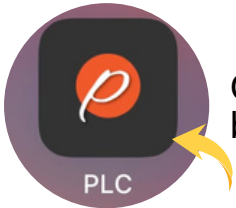

Once the application is downloaded, open it by clicking the PLC Icon on your device.



After opening the application, click on the messaging icon at the top right of your screen.

Follow the sequence of screens below.

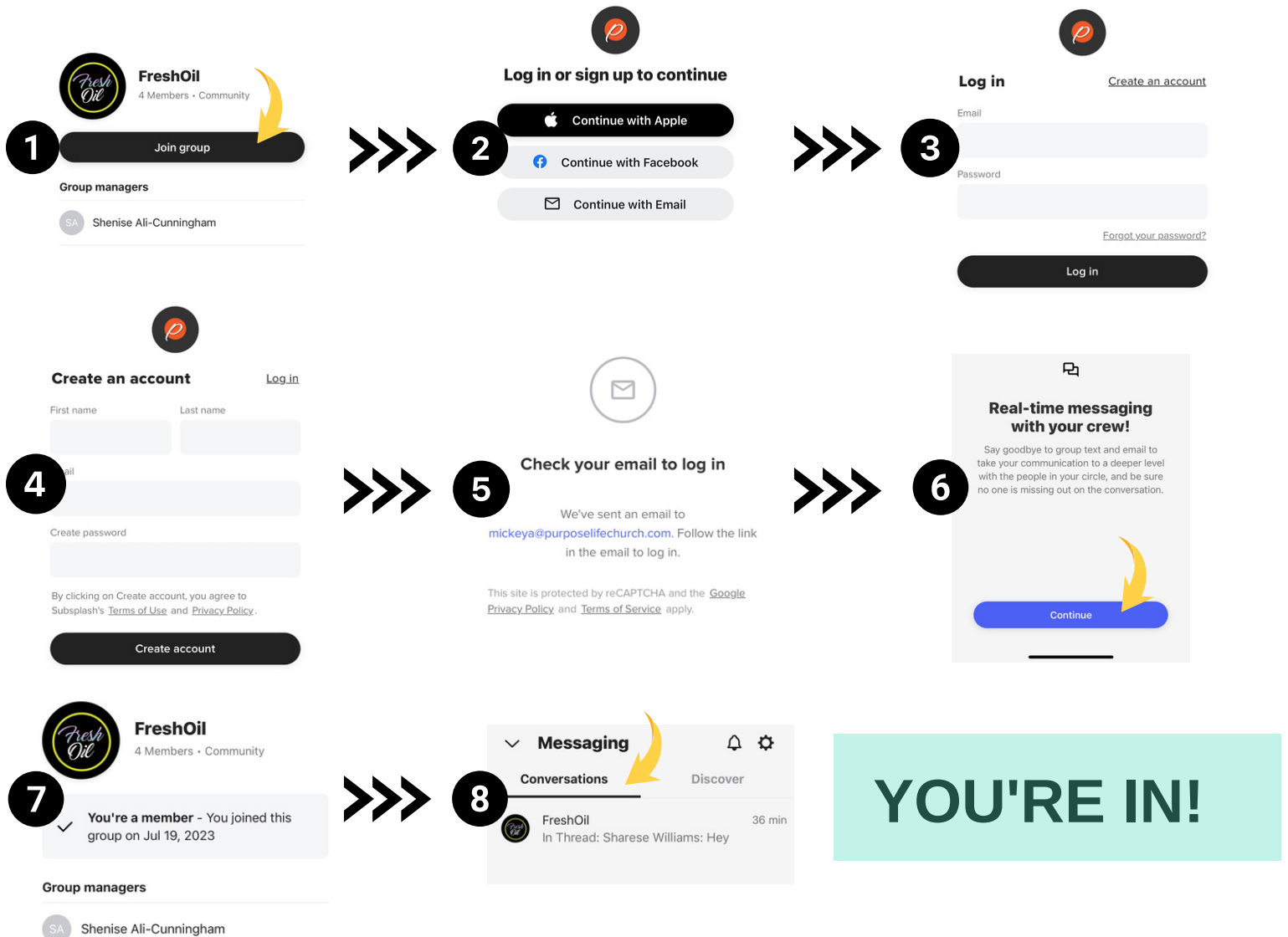

contact us

pastorsjw@purposelifechurch.com



www.purposelifechurch.com

PASTOR SHARESE'S TEAM



naomi



shenise



micheya